

DRAWING NUMBER 090072014		SIZE 4
TOLERANCE FOR ASSEMBLY		
DIVISION DIMENSION	TOLERANCE (IT 12)	
-10	±0.08	
10-30	±0.11	
30-50	±0.13	
50-80	±0.15	
80-120	±0.18	
120-180	±0.20	
180-250	±0.23	
250-315	±0.26	
315-400	±0.29	
400-500	±0.32	
500-630	±0.35	
630-800	±0.40	
800-1000	±0.45	

FIXING TORQUE KGF.CM				
ITEM	TARGET	MIN.	MAX.	
1.3/1.5	20	18.4	23	
1.6	30	27.6	32.2	
1.7.3.1	16	15	17.2	
1.7.3.2	15.5	14	17	
2.3	43	40.3	46	
2.4	93	86.4	97.9	
2.7	155	138.2	172.8	
2.8.7	34	30	38	
10	23	17.3	28.8	
13.1	17.5	15	20	

REVISIONS				
REV	ZONE	DESCRIPTION	ECM	CHECKED
01		DESIGN RELEASE	XXXXXXXXXX	XXXXXXXXXXXX
COMPUTERIZED DOCUMENT NO MANUAL REVISIONS PERMITTED				

PRELIMINARY

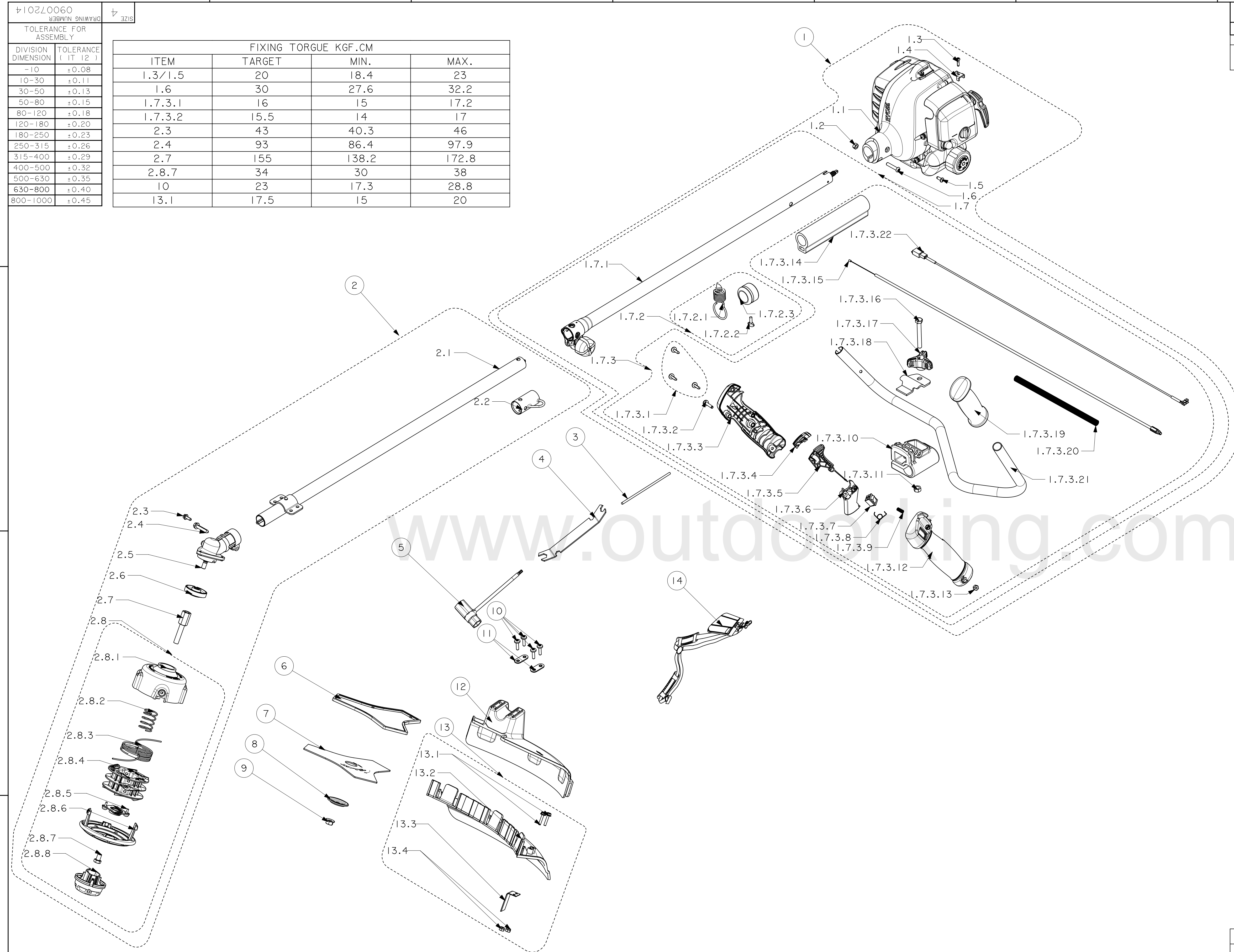

PRELIMINARY

NOTES:
 (M) 1. REFER TO COMPONENT DRAWING FOR INSPECTION CRITERIA
 2. SEE QUALITY ASSURANCE FOR ADDRESSING CRITICAL AND MAJOR DIMENSIONS
 TOTAL (C) THIS PAGE = 0
 TOTAL (M) THIS PAGE = 1

090072014	25.4cc RYOBI PETROL STRAIGHT SHAFT BRUSHCUTTER RBCGM25BB	AS PURCHASED
PART NUMBER	DESCRIPTION	REMARKS
TTI GROUP NORTH AMERICA		
25.4cc RYOBI PETROL STRAIGHT SHAFT BRUSHCUTTER RBCGM25BB		
SCALE	DRAWING NUMBER	REV
NONE	090072014	01
SHEET 1 OF 1		

M.S.
 P.S.
 DIST --- PURCH/FAB p
 UNLESS OTHERWISE SPECIFIED DIMENSIONS ARE IN MILLIMETERS.
 FOR ALL UNSPECIFIED DIMENSIONS PLEASE REFER TO THE CAD FILE.
 DO NOT SCALE.
 USE DIMENSIONS ONLY.
 DIMENSION & TOLERANCE PER ASME Y14.5-2009
 THIRD ANGLE PROJECTION

RBCGM25BB - A: EXPLODED VIEW

Ref	Part #	Title
1	100970014	25.4CC FULL CRANK POWER HEAD & UPPER BOOM ASS'Y \ BIKE HANDLE
1.1	308277013	25.4CC FULL CRANK POWER HEAD ASS'Y
1.2	678029002	NUT,HEX,M6X1,BLACK OXIDE
1.3	660669001	SCREW
1.4	638133001	CLIP-THROTTLE CABLE RETAINING
1.5	660734001	SCREW, M4X1.75X16
1.6	660697001	ST SCREW,M6X1X30
1.7	308278020	UPPER BOOM AND BIKE HANDLE ASS'Y
1.7.1	308159008	UPPER BOOM ASS'Y\BLACK
1.7.2	308188001	HANGER & COLLAR ASS'Y
1.7.2.1	678030001	SPRING,HANGER
1.7.2.2	660652001	SCREW,#10-24X1/2" UNC-2A
1.7.2.3	518035001	COLLAR
1.7.3	308058028	BIKE HANDLE ASS'Y / 25.4CC BLK TUBE
1.7.3.1	660623002	ST SCREW, #8-16X1"
1.7.3.2	660651001	SCREW
1.7.3.3	518026004	HANDLE RH
1.7.3.4	518022009	PLASTIC,BUTTON,HALF THROTTLE
1.7.3.5	518021009	PLASTIC,THROTTLE,LOCKOUT LEVER
1.7.3.6	518023009	TRIGGER
1.7.3.7	760345001	SWITCH
1.7.3.8	678031001	SPRING THROTTLE RETURN
1.7.3.9	678032001	SPRING THROTTLE BUTTON RETURN
1.7.3.10	518033001	BRACKET MOUNTING HANDLE BAR
1.7.3.11	678029001	NUT,5/16-18 UNC-2B
1.7.3.12	518025004	HANDLE LH
1.7.3.13	678027001	NUT, # 10-24\81208
1.7.3.14	518034001	GRIP HANDLE BAR FOAM SPACER [Replaced with 518034003 once stock is depleted]
1.7.3.15	308225006	THROTTLE CABLE
1.7.3.16	660646001	SCREW,5/16-18UNC-2A
1.7.3.17	518027002	KNOB CLAMPING
1.7.3.18	638021001	CLAMP
1.7.3.19	570234006	PLASTIC SOFT,GRIP,LEFT HAND ASSIST
1.7.3.20	518036003	SLEEVE WIRING

1.7.3.21	638022004	HANDBAR,ALUMINUM
1.7.3.22	308863009	LEAD WER ASM
2	310886003	LOWER STRAIGHT SHAFT AND GREY REEL EASY STRING HEAD ASS'Y
2.1	308035006	BRUSHCUTTER LOWER DRIVE
2.2	518019002	END CAP-STORAGE
2.3	660641001	ST SCREW #10-24 X5/8"
2.4	660642001	ST SCREW 1/4-20 X 1.25"
2.5	308210001	GEAR BOX ASS'Y
2.6	678011001	FLANGED WASHER
2.7	678019003	ARBOR,STRING HEAD
2.8	308923016	STRINGHEAD ASM-LX50
2.8.1	518800006	MAIN HOUSING - LX50
2.8.2	678749001	COMPRESSION SPRING
2.8.3	900880009	CUTTING LINE-0.095" RED
2.8.4	518801003	SPOOL - LX50
2.8.5	518802003	SPOOL COVER - LX50
2.8.6	518804004	LOWER HOUSING - LX50
2.8.7	660649001	SCREW,5/16-18UNC-2A LH
2.8.8	518803004	BUMP KNOB - LX50
3	678020001	HOLDING PIN
4	638015001	COMBINATION WRENCH
5	631055004	COMBINATION WRENCH
6	518018001	PLASTIC BLADE COVER
7	638006001	TRIAC BLADE
8	638017001	CUPPED WASHER
9	678018001	NUT M8X1.25,LOCK,LH
10	660644001	SCREW
11	308048001	MOUNTING PLATE ASSY
12	518017001	BLADE GUARD
13	308057001	STRING SHIELD ASS'Y
13.1	660645001	SCREW, #10-24X7/8
13.2	518016001	PLASTIC STRING SHIELD
13.3	638016001	BLADE, CUT OFF
13.4	678017001	NUT, #10-24
14	900877002	HARNESS ASSEMBLY W/HIP PAD